

生物物理化学

Japanese Journal of Electrophoresis

1999

第 49 回日本電気泳動学会春季大会抄録号

VOL.43 補冊 1

Electrophoresis '99

Meeting of the International Council of
Electrophoresis Societies



ICES '99

May 25(Tue.)-28(Fri.), 1999, Tokyo, JAPAN

Program and Abstracts

日本電気泳動学会発行

<http://www.tmig.or.jp/JES/>

GREETINGS

Dear Colleagues:

On behalf of the International Council of Electrophoresis Societies, we welcome you to the Meeting of the International Council of Electrophoresis Societies (ICES '99).

Since the modern history of electrophoresis originated with Prof. A. Tiselius in Sweden in 1937, the scientific, technical and applied fields of electrophoresis flourished all over the world. Hence, the first International Congress of Electrophoresis was held at Munich in 1979, then at Charlston and Athens, and Tokyo in 1983. The Congress grew over the years and was finally reorganized as ICES.

ICES '99 deals with a broad range of topics: Advances in Electrophoresis Techniques, Electrophoresis Biology, Medical Sciences, and Application of Electrophoretic Techniques. The aim of the meeting is to provide a forum for the exchange of the latest information and active discussions. We are also pleased to announce that we have at this meeting world's leading researchers in the field of electrophoresis as our guest speakers and many others who have come from many parts of the world to present their work. We hope that this meeting will provide a huge step forward in your study.

For participants from overseas, we have prepared various programs so you can enjoy every aspect of Japanese tradition and culture. We hope you will take this opportunity to learn about our country and enjoy your stay.



Nobuya Hashimoto

Nobuya Hashimoto
President, ICES '99

Dear Colleagues:

It is my great pleasure to invite you to the Meeting of the International Council of Electrophoresis Societies (ICES '99) in Tokyo.

This year's meeting will focus on new challenges giving an impact on electrophoresis looking at the coming 21st Century. Speakers will cover up-to-date electrophoretic subjects and scientific interests. Also, there will be oral and poster sessions which will provide you the chances to exchange scientific information with each other.

Omiya, one of the most important satellite cities of Tokyo and new expanding city of arts, science and culture, welcomes this important scientific event with great warmth. The city is also surrounded by the enchanting legacy of a glorious civilization (Kawagoe city, Nikko, etc.) and beautiful nature.

Sonic City, a modern congress structure, is neighboring a traditional structure of Hikawa Shrine built more than 2400 years ago as well as the Bonsai Village where many people gain skills and become masters of bonsai. They will provide an unforgettable background to our meeting at end of this century.

I hope this meeting will certainly inspire your activities and provide you an opportunity to exchange international friendship. I hope to see you in Omiya.



I. Sakurabayashi

Ikunosuke Sakurabayashi
Chairman, Organizing Committee

ORGANIZATION

■ Organizing Committee

President: N. Hashimoto

Chairman: I. Sakurabayashi

T. Honjo, T. Horio, S. Iino, K. Imai, T. Kanno, T. Kawai, Y. Makino, T. Manabe,
K. Miki, K. Nakamura, S. Nishi, M. Ohashi, K. Shiba, K. Sudo, K. Takeo,
K. Taketa, N. Taniguchi, T. Toda, N. Yoshioka

■ Program Committee

N. Hashimoto, H. Hirano, T. Horio, K. Imai, T. Isobe, T. Komoda, T. Manabe,
K. Nakamura, S. Nishi, M. Ohashi, I. Sakurabayashi, K. Sudo, N. Taniguchi,
S. Terabe, T. Toda, N. Yoshioka

■ International Advisory Board

Josie Beeley (UK)

Andreas Chrambach (USA)

Michael J. Dunn (UK)

Angelika Görg (Germany)

Stellan Hjerten (Sweden)

Denis F. Hochstrasser (Switzerland)

Barry L. Karger (USA)

Gabriel Peltre (France)

Pier G. Righetti (Italy)

Nancy Stellwagen (USA)

Brad Walsh (Australia)

■ Secretariat

Inter Group Corporation

Akasaka Dai-ichi Building

4-9-17 Akasaka, Minato-ku

Tokyo 107-8486, Japan

Phone: +81-3-3479-5875 Fax: +81-3-3423-1600

E-mail: ices99@2dwww.tmig.or.jp

■ Official Travel Agency

Japan Travel Bureau, Inc. (JTB)

International Travel Division

Convention Center (CD100993-708)

5-5-2 Kiba, Koto-ku, Tokyo 135-8520, Japan

Phone: +81-3-5620-9429 Fax: +81-3-5620-9499

E-mail: ices@itd.jtb.co.jp

Contents

Electrophoresis '99

[Time Table]	(1)
[Floor Plan]	(2)
[Scientific Program]	
Lecture Sessions	(3)
Poster Sessions	(11)
[Internet Online Poster Sessions]	(23)
[Luncheon Seminars]	(23)
[General Information]	(24)
[Optional Tours]	(27)
[Access to Meeting Site]	(28)
[Abstracts]	
Lecture Sessions	1
Poster Sessions	41
Luncheon Seminars	117
[Commercial Exhibit]	120
[Authors' Index]	124
[Acknowledgements]	133

(This project has been executed with a grant from the Commemorative Association for the Japan World Exposition (1970))

Copyright © 1999 the Japanese Electrophoresis Society

Notice about photocopying: In order to photocopy any work from this publication, you or your organization must obtain permission from the following organization which has been delegated for copyright for clearance by the copyright owner of this publication. **Except in the USA:** Japan Academic Association for Copyright Clearance (JAACC), 9-6-41, Akasaka, Minato-ku, Tokyo 107-0052, Japan. TEL: 81-3-3475-5618, FAX: 81-3-3475-5619, E-mail: kammori@msh.biglobe.ne.jp. **In the USA:** Copyright Clearance Center, Inc., 222 Rosewood Drive, Danvers, MA 01923, USA. TEL: 978-750-8400, FAX: 978-750-4744, www.copyright.com

TIME TABLE

DATE	ROOM	9:30	12:00	13:00	14:00	15:00	16:00	17:00	18:00	19:00	20:00	
May 24 (Mon.)	IMH									Welcome Reception		
May 25 (Tue.)	LH	Opening, Hirai Prize Special Lectures			Plenary Session (Electrophoresis Now)							
	IMH				Luncheon Seminar 1						Mixer (Civil Hall, 4F)	
	EH	Poster Exhibit · Commercial Exhibit										
May 26 (Wed.)	LH	Electrophoresis of Cells/Particles		2-D Gel Electrophoresis for Proteomics and Genomics								
	IMH	Affinity Electrophoresis		Luncheon Seminar 2		Protein Electrophoresis in Pathological Biochemistry						
	EH	Poster Exhibit · Commercial Exhibit										
May 27 (Thu.)	LH	Proteome and Protein Database		Combination of Electrophoresis with Mass Spectrometry								
	IMH	Lipoprotein, Apolipoprotein and Its Clinical Significance		Luncheon Seminar 3		Cell Function Analysis		Banquet (Palace Hotel, 4F)				
	EH	Poster Exhibit · Commercial Exhibit										
May 28 (Fri.)	LH	Capillary Electrophoresis 1		Capillary Electrophoresis 2		Poster Award, Closing Lecture/ Remarks						
	IMH	DNA Electrophoresis in Molecular Pathology		Electrophoresis in Genetic and Forensic Analysis								
	EH	Poster Exhibit · Commercial Exhibit										

IMH: International Meeting Hall (International Meeting Hall, Hall Wing, 4F)

LH: Lecture Hall (Small Hall, Hall Wing, 2F)

EH: Exhibition Hall

Registration (Hall Wing, 4F)

May 24 17:00-18:30

May 25-27 9:00-17:00

May 28 9:00-13:00

Social Programs

Welcome Reception: May 24 18:00-20:00 (International Meeting Hall, Hall Wing, 4F)

Mixer: May 25 18:30-20:30 (Civil Hall, Building Wing, 4F)

Banquet: May 27 18:30-20:30 (Rose Room, Palace Hotel, 4F)

FLOOR PLAN

B1

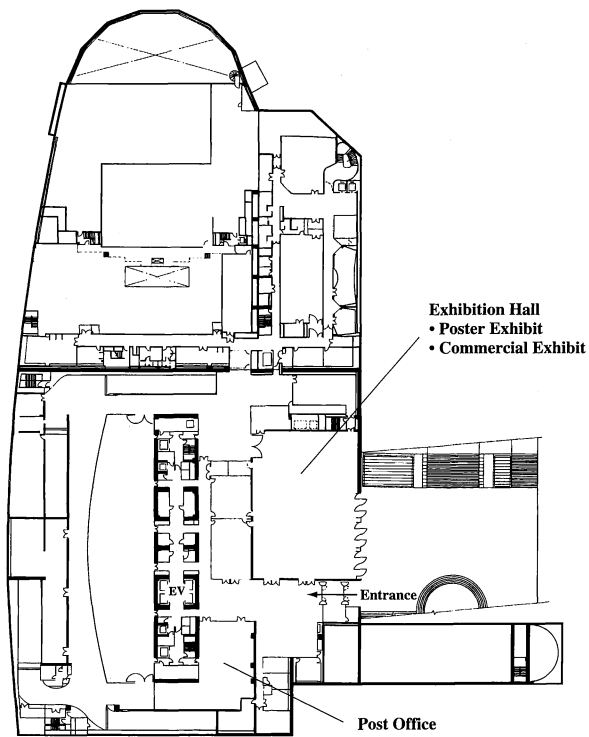

1F

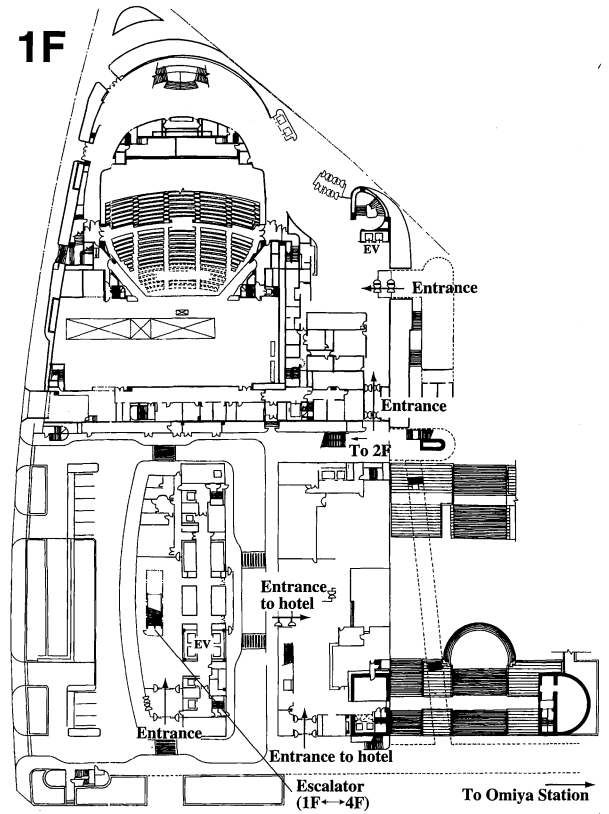

2F

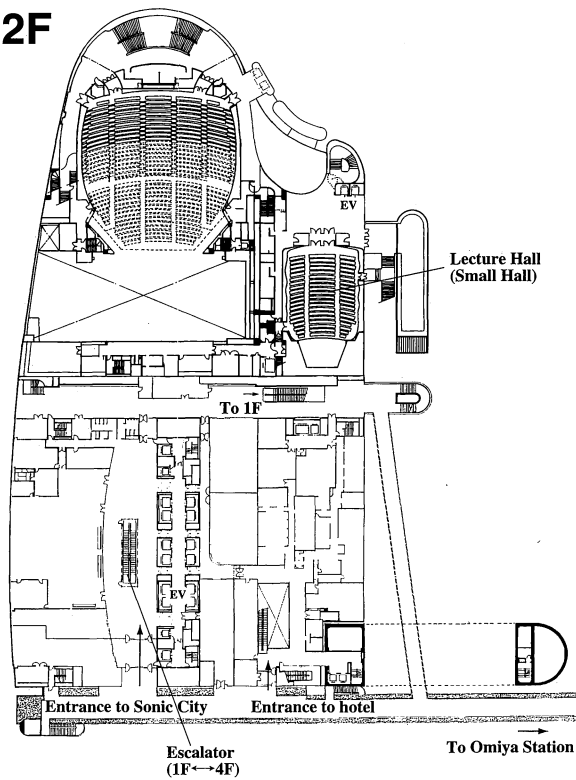

4F

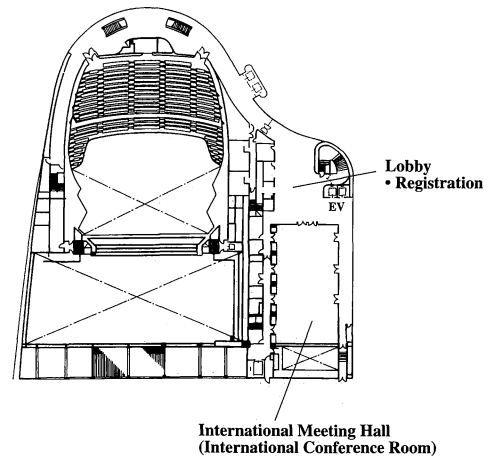

SCIENTIFIC PROGRAM

May 25, Tuesday

(Lecture Hall)

■ **Opening Remarks**

9:40- 9:50 Ikunosuke Sakurabayashi (Omiya Medical Center, Jichi Medical School, Japan)

■ **Hirai Prize Ceremony**

9:50-10:00 Nobuya Hashimoto (Jikei University School of Medicine, Japan)

■ **Lecture Session 1 (LS-1): Special Lectures (Joint Session with 49th Annual Meeting of Electrophoresis Society)**

Chairperson: N. Hashimoto (Japan)

10:00-10:50 Hirai Prize Lecture 1

Novel Electrophoresis Supports and Analysis of Biological Macromolecules
Pier Giorgio Righetti (University of Verona, Italy)

10:50-11:40 Hirai Prize Lecture 2

Two-Dimensional Gel Electrophoresis and Human Protein Databases
Julio E. Celis (University of Aarhus, Denmark)

11:40-12:00 Break

12:00-12:20 50 Years of Japanese Electrophoresis Society

Nobuya Hashimoto (Jikei University School of Medicine, Japan)

12:20-12:40 20 Years of Electrophoresis

Bertold J. Radola (Technical University Munich, Germany)

12:40-15:00 Lunch, Luncheon Seminar 1 (International Meeting Hall)

Poster Visit (Exhibition Hall)

■ **Lecture Session 2 (LS-2): Plenary Session "Electrophoresis Now"**

Chairpersons: K. Taketa (Japan), T. Manabe (Japan)

15:00-15:30 In Pursuit of the Perfect Electrochromatographic Medium

Stellan Hjerten (Uppsala University, Sweden)

15:30-16:00 Particle Electrophoresis for Quality Assurance and Process Control in
Biotechnology, Diagnostics and Pharmaceuticals

Geoffrey V.F. Seaman (Emerald Diagnostics Inc., USA)

16:00-16:30 Newer Genotyping Methods – From Hand Made Gels to Automated Capillary
Systems

Carl-Henrik Brogren (Institute of Food Safety and Toxicology, Denmark)

16:30-16:50 Break

16:50-17:20 Current Status of Proteome Research

K.L. Williams (Australian Proteome Analysis Facility and Macquarie University,
Australia)

17:20-17:50 Glycosyltransferase Genes: Regulation and Expression

Naoyuki Taniguchi (Osaka University School of Medicine, Japan)

May 26, Wednesday

(Lecture Hall)

■ Lecture Session 3 (LS-3): Electrophoresis of Cells and Particles

Chairpersons: J. Bauer (Germany), W. Schütt (Germany)

- 9:30- 9:50 Possibilities to Increase Resolution of Free Flow Zone Electrophoresis
Johann Bauer (Max-Planck-Institut f. Biochemie, Germany)
- 9:50-10:10 Electrophoretic Purification and Characterization of Plasma Membrane Receptors in *Arabidopsis Thaliana*
Hervé Canut (UPS-CNRS, France)
- 10:10-10:30 The Importance of Electrophoretic Properties of Magnetic Polymer Carriers
Cordula Grüttner (Micro Caps GmbH Rostock, Germany)
Wolfgang Schütt (Jikei University School of Medicine, Japan; JMS Co., Ltd., Japan)
Nobuya Hashimoto (Jikei University School of Medicine, Japan)
- 10:30-10:50 Mammalian Pituitary Growth Hormone: Applications of Continuous Flow Electrophoresis
W.C. Hymer (The Pennsylvania State University, USA)
- 10:50-11:00 Break
- 11:00-11:20 Covalent Binding of Polyethylene Glycol (PEG) to the Surface of Red Blood Cells (RBC) as Detected and Followed up by Electrophoretic Mobility Analysis
Domagoj Sabolovic (INSERM, France)
- 11:20-11:40 Electrophoresis and Field-Flow Fractionation in Electric Double Layer Observed by Dynamic Light Scattering as Possible Analytical Instrument
S.N. Semeonov (Institute of Biochemical Physics RAS, Russia)
- 11:40-12:00 Multistage Electrophoresis and Magnetic Separation of Cells, Particles and Solutes
Paul Todd (University of Colorado, USA)
- 12:00-12:20 Recent Instrumental Developments in Free Flow Electrophoresis
Gerhard Weber (Dr. Weber GmbH, Germany)
- 12:20-15:00 Lunch, Luncheon Seminar 2 (International Meeting Hall)
- 13:30-14:50 Poster Discussion 1 (Exhibition Hall)

(International Meeting Hall)

■ Lecture Session 4 (LS-4): Affinity Electrophoresis

Chairpersons: T.C. Bøg-Hansen (Denmark), K. Takeo (Japan)

- 9:30- 9:55 Affinity Electrophoresis for Qualitative and Quantitative Binding Studies
Niels H.H. Heegaard (Statens Serum Institute, Denmark)
- 9:55-10:20 Affinophoresis: A Mobile Affinity-Electrophoresis System
Kiyohito Shimura (Teikyo University, Japan)
- 10:20-10:45 Affinity Capillary Electrophoresis
M.A. Vijayalakshmi (Centre de Recherches de Royallieu, France)

10:45-11:00 Break

11:00-11:25 **Comparison of Lectin-Binding Patterns between Young Adult and Older Rat Glycoproteins in Brain**

Yuji Sato, Mika Kimura and Tamao Endo (Tokyo Metropolitan Institute of Gerontology, Japan)

11:25-11:50 **Antigen-Antibody Specificity and Avidity Studied by Blotting Techniques after Electrophoretic Separations**

Gabriel Peltre (Institut Pasteur, France)

11:50-12:15 **Two-Dimensional Affinity Electrophoresis for Studies of Immune Responses**

Kazuyuki Nakamura, Yusuke Mimura, Tatehiko Tanaka and Kazusuke Takeo (Yamaguchi University, School of Medicine, Japan)

12:15-15:00 Lunch, Luncheon Seminar 2 (International Meeting Hall)

13:30-14:50 Poster Discussion 1 (Exhibition Hall)

(Lecture Hall)

■ Lecture Session 5 (LS-5): Two-Dimensional Gel Electrophoresis for Proteomics and Genomics

Chairpersons: A. Görg (Germany), T. Toda (Japan)

15:00-15:20 **Proteomics Technology Development in Geneva**

Denis F. Hochstrasser (Geneva University Hospital, Switzerland)

15:20-15:40 **Recent Developments in IPG-Dalt: Wide pH Gradients up to pH 12, Longer Separation Distances and Simplified Procedures**

Angelika Görg (Technical University of Munich, Germany)

15:40-15:55 **Combining Sequential Extraction and Multiple Overlapping pH Gradients to Allow Rapid Two-Dimensional Separations of Complex Samples**

Ben R. Herbert, M.P. Molloy, A.A. Gooley, and K.L. Williams (Macquarie University, Australia)

15:55-16:15 **Quantitative Aspect of Two-Dimensional Gel Electrophoresis and Protein Database for Research on Molecular Mechanisms of Aging**

T. Toda and N. Kimura (Tokyo Metropolitan Institute of Gerontology, Japan)

16:15-16:30 Break

16:30-16:50 **Agarose IEF for the Detection of Many Isoforms and High Molecules in Muscle Protein Analysis**

Tamio Hirabayashi and Jun-Ichi Miyazaki (Tsukuba University, Japan)

16:50-17:10 **Comparisons of Human Plasma Protein Patterns Obtained by Four Techniques of Two-Dimensional Gel Electrophoresis to Detect Protein-Protein Interactions**

Takashi Manabe (Ehime University, Japan)

17:10-17:30 **High Resolution Two-Dimensional Electrophoresis of End-Labeled Genomic DNA Fragments**

Jun-ichi Asakawa (Radiation Effects Research Foundation, Japan)

(International Meeting Hall)

■ Lecture Session 6 (LS-6): Protein Electrophoresis in Pathological Biochemistry Chairpersons: J.L. Millan (Sweden), T. Komoda (Japan)

- 15:00-15:25 **Testis-Specific Gene Expression and Its Significance to Fertility Research: Lessons from Idh-c and Cytochrome Ct**
José Luis Millán (The Burnham Institute, USA)
- 15:25-15:50 **Localization and Function of Bone Alkaline Phosphatase**
Viviane Van Hoof (University Hospital Antwerp, Belgium)
- 15:50-16:15 **Reactive Oxygen Species Generated by Glycation Cause a Breakdown of Bone Alkaline Phosphatases**
I. Koyama (Saitama Medical School, Japan)
- 16:15-16:30 **Break**
- Chairpersons: V. Van Hoof (Belgium), K. Suzuki (Japan)
- 16:30-16:55 **Involvement of Calcium and Protein Kinase C (PKC) in the Signal Transduction Pathway of P125FAK and Paxillin Tyrosine Phosphorylation by Cyclical Stretch/Relaxation in Cultured Rat Mesangial Cells**
S. Kondo (St. Marianna University, Japan)
- 16:55-17:20 **Oxidative Stress and Apoptosis**
Keiichiro Suzuki (Osaka University Medical School, Japan)

May 27, Thursday

(Lecture Hall)

■ Lecture Session 7 (LS-7): Proteome and Protein Database Chairpersons: J.E. Celis (Denmark), H. Hirano (Japan)

- 9:30-9:55 **Microsequence Analysis of N-Terminally Blocked Proteins Separated by 2-D Gel Electrophoresis**
H. Hirano (Yokohama City University, Japan)
- 9:55-10:20 **Mass Spectrometry of Nucleic Acids and Proteins in Genome and Proteome Analyses**
Hisaaki Taniguchi (Fujita Health University, Japan)
- 10:20-10:45 **Proteome Analysis of Rat Cerebellar Proteins**
T. Isobe (Tokyo Metropolitan University, Japan)
- 10:45-11:10 **Proteomic Analysis of Heart Disease and Transplantation**
M.J. Dunn (National Heart and Lung Institute, UK)
- 11:10-11:25 **Break**
- 11:25-11:50 **Interface of Genome and Proteome**
T. Sazuka (Kazusa DNA Research Institute, Japan)
- 11:50-12:15 **Analysis of Post-Translational Modifications in Proteins and Proteomes**
R. Aebersold (University of Washington, USA)

12:15-12:40 **Proteomic 2D PAGE Databases: Novel Resources for the Study of the Proteome in Health and Disease**

J.E. Celis (Aarhus University, Denmark)

12:40-15:20 **Lunch, Luncheon Seminar 3 (International Meeting Hall)**

13:50-15:10 **Poster Discussion 2 (Exhibition Hall)**

(International Meeting Hall)

■ Lecture Session 8 (LS-8): Lipoprotein, Apolipoprotein and Its Clinical Significance

Chairpersons: L.K. Curtiss (USA), I. Sakurabayashi (Japan)

9:30-9:55 **Apolipoprotein E and Atherosclerosis**

Linda K. Curtiss (The Scripps Research Institute, USA)

9:55-10:20 **Molecular Analysis of Apolipoprotein Mutants**

Jun Sasaki (Fukuoka University, Japan)

10:20-10:45 **Clinical Implication of LDL-Cholesterol Measurement**

Nader Rifai (Children's Hospital, USA)

10:45-11:10 **Gene Expression in Macrophages Accumulated with Degenerated Lipoproteins**

Yusuke Furukawa (Center for Molecular Medicine, Jichi Medical School, Japan)

11:10-11:25 **Break**

11:25-11:50 **Presence of Oxidized LDL- α 1 Antitrypsin Complex in Human Serum and Its Clinical Significance**

Kazuo Uchida, Shinichi Mashiba (Kyoto Medical Research Institute, Japan)

Ikunosuke Sakurabayashi (Omiya Medical Center, Jichi Medical School, Japan)

Tatsuhiko Kodama (Tokyo University, Japan)

11:50-12:15 **Atherosclerosis and Small Dense LDL**

Gen Yoshino (Toho University, School of Medicine, Japan)

12:15-15:20 **Lunch, Luncheon Seminar 3 (International Meeting Hall)**

13:50-15:10 **Poster Discussion 2 (Exhibition Hall)**

(Lecture Hall)

■ Lecture Session 9 (LS-9): Combination of Electrophoresis with Mass Spectrometry

Chairpersons: A. Burlingame (USA), T. Isobe (Japan)

15:20-15:45 **Assemblages and Machines Using 2-D Gel Electrophoresis, Advanced Mass Spectrometry and Genomic Database Interrogation**

A. Burlingame (Univ. California, San Francisco, USA; Ludwig Institute of Cancer Research, UK; University College of London, UK)

15:45-16:10 **Differential Scanning for De Novo Sequencing: Mass Spectrometry Overcomes the Species Boundary for Protein Sequencing**

Matthias Wilm, Gitte Neubauer and Angela Bachi (EMBL, Germany)

16:10-16:35 **Proteomics Using the Combined Systems of Multi-Dimensional Separation Techniques and Mass Spectrometry**
Kazuo Seta (Tokyo Metropolitan University, Japan; PE Biosystems, Japan)

16:35-16:50 **Break**

16:50-17:15 **Proteomic Approach to the Identification of Cell Membrane Proteins: Analysis by Two Dimensional Electrophoresis and MALDI-TOF Mass Spectrometry**
Toshihiko Kadoya (Kirin Brewery Co., Ltd., Japan)

17:15-17:40 **Bioproteomics and Colon Cancer**
Richard J. Simpson (Ludwig Inst., Australia)

(International Meeting Hall)

■ **Lecture Session 10 (LS-10): Cell Function Analysis**
Chairpersons: A. Sobel (France), K. Nakamura (Japan)

15:20-15:45 **Regulation of Invasive Growth of Tumor Cells by Matrix Proteinases and Cell Adhesion Proteins**
Kaoru Miyazaki (Yokohama City University, Japan)

15:45-16:10 **Stathmin, Its Family and Partners in Intracellular Signal Relay and Integration**
Andre Sobel (INSERM, France)

16:10-16:35 **Isolation of Subpopulations of Human Myeloma Cells by a Cell Sorter and Their Proliferative Response to Interleukin-6**
Hideaki Ishikawa (Yamaguchi University School of Medicine, Japan)

16:35-16:50 **Break**

16:50-17:05 **Analysis of Galectin 1-Mediated Cell Signaling by Combined Precipitation and Electrophoresis Techniques***
Michael Caron (Université Paris-Nord, France)
*Nominated from the list of presentation in ICES '99

17:05-17:30 **Neuronal Activity-dependent Genes Associated with Survival and Apoptosis of Cerebellar Granule Neurons**
T. Ono, N. Suzuki and K. Kawashima (Tokyo Metropolitan Institute of Medical Science, Japan)

May 28, Friday

(Lecture Hall)

■ **Lecture Session 11 (LS-11): Capillary Electrophoresis 1**
Chairpersons: P.G. Righetti (Italy), S. Terabe (Japan)

9:30-9:55 **Capillary Electrophoresis in Clinical Analysis**
Wolfgang Thormann (University of Bern, Switzerland)

9:55-10:20 **Fluorescence-Labeled Peptide pI Markers for Capillary Isoelectric Focusing with Fluorescence Detection - Labeling at a Cysteine Residue**
Kiyohito Shimura (Teikyo University, Japan)

10:20-10:45 **Aptamers and Antibodies as Ligands in High-Speed Assays by Capillary Electrophoresis**
Robert T. Kennedy (University of Florida, USA)

10:45-11:00 **Break**

11:00-11:25 **Improvement of Detection Sensitivity in Micellar Electrokinetic Chromatography**
Shigeru Terabe (Himeji Institute of Technology, Japan)

11:25-11:50 **CZE Electropherogram with Effective Mobility Axis and Its Analytical Utility (II)**
Takesi Hirokawa (Hiroshima University, Japan)

11:50-13:00 **Lunch, Poster Visit (Exhibition Hall)**

(International Meeting Hall)

■ **Lecture Session 12 (LS-12): DNA Electrophoresis in Molecular Pathology**
Chairpersons: A.E. Reeve (New Zealand), K. Imai (Japan)

9:30-9:55 **Molecular Changes in Human Gastrointestinal Tumors**
Hiroyuki Yamamoto (Burnham Institute, USA)

9:55-10:20 **Role of Genomic Imprinting in Embryonal Tumourigenesis**
Anthony E. Reeve (University of Otago, New Zealand)

10:20-10:45 **DNA Methylation Alterations in Cancer**
Fumiichiro Yamamoto (Burnham Institute, USA)

10:45-11:00 **Break**

11:00-11:25 **Significance of Methylation of Genes**
Minoru Toyota (Johns Hopkins Oncology Center, USA)

11:25-11:50 **Immunogene Therapy for Cancer**
David P. Carbone (Vanderbilt Cancer Center, USA)

11:50-13:00 **Lunch, Poster Visit (Exhibition Hall)**

(Lecture Hall)

■ **Lecture Session 13 (LS-13): Capillary Electrophoresis 2**
Chairpersons: S. Honda (Japan), R. Kennedy (USA)

13:00-13:20 **Studies of Carbohydrate-Protein Interaction by Capillary Electrophoresis**
Susumu Honda (Kinki University, Japan)

13:20-13:45 **Capillary Electrochromatography on Antidepressant Drugs**
Douglas Westerlund (Uppsala University, Sweden)

13:45-14:10 **Chemical Integrated Circuits**
Andrew J. De Mello (Imperial College of Science, UK)

14:10-14:30 **Integrated Analytical System on a Glass Chip-reaction, Separation and Detection in Liquid Micro Space**
Takehiko Kitamori (The University of Tokyo, KAST, Japan)

14:30-14:50 **Microfabricated Capillary Array Electrophoresis Chip for Genome and Proteome Analysis**
Yoshinobu Baba (The University of Tokushima, Japan)

14:50-15:00 Break

(International Meeting Hall)

■ **Lecture Session 14 (LS-14): Electrophoresis in Genetic and Forensic Analysis**
Chairpersons: F. Yamamoto (USA), N. Yoshioka (Japan)

13:00-13:25 **Nucleotide Changes Underlying Genetic Polymorphisms of Protein in Serum and Blood Cells**
Koichi Suzuki (Osaka Medical College, Japan)

13:25-13:50 **Sequence and Length Polymorphism at the ACTBP2 Short Tandem Repeat Locus**
Burkhard Rolf (Universität München, Germany) and Bernd Brinkmann
(Westfälische Wilhelms-Universität, Germany)

13:50-14:15 **Histo-Blood Group ABO System: Structure and Function Analysis of Genes and Gene Products**
Fumiichiro Yamamoto (Burnham Institute, USA)

14:15-14:40 **Structure Properties and Biological Functions of Human Blood Group Antigens**
Jean Pierre Cartron (Institut National de la Santé et de la Recherche Médicale
(U76), France)

14:40-15:00 Break

(Lecture Hall)

■ **Poster Award**
15:00-15:20

■ **Closing Lecture (CL)**
Chairperson: T. Manabe (Japan)

15:20-16:00 **From Genome to Proteome: A New Look at Nature Complexity**
Denis F. Hochstrasser (Geneva University Hospital, Switzerland)

■ **Closing Remarks**
16:00-16:05 Nobuya Hashimoto (Jikei University School of Medicine, Japan)

POSTER SESSIONS

(Exhibition Hall)

Poster Exhibit

May 25 (Tue.) - May 27 (Thu.) 9:30-18:00
May 28 (Fri.) 9:30-16:00

Poter Discussion

1: May 26 (Wed.) 13:30-14:50 (For posters in odd numbers)
2: May 27 (Thu.) 13:50-15:10 (For posters in even numbers)

*Presenters are requested to stand in front of their panels for questions and answers during the discussion time indicated above.

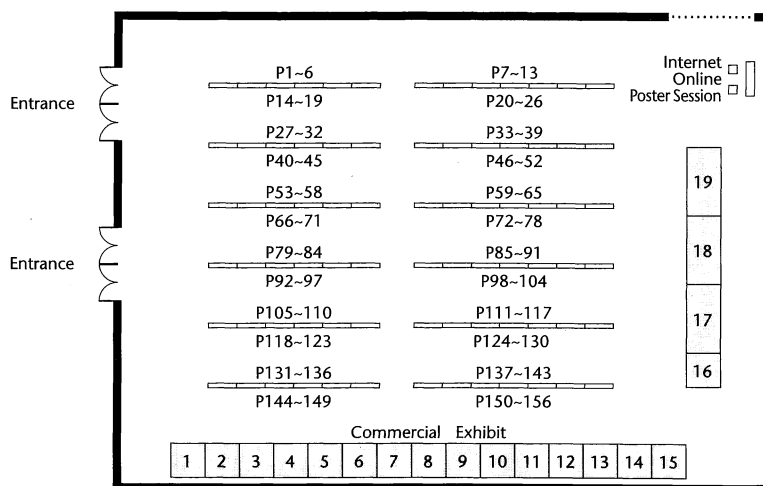

Electrophoresis of Cells and Particles

- P-1** Application of Free-flow Electrophoresis to the Separation of Murine Lymphocytes
T. Liu, X. Shen, G.-D. Wu, Q.-C. Xia, S.-N. Wang, Z.-J. Wu and W. Hu (China)
- P-2** Characteristics of Highly Disperse Oxides and Interaction with Polymers
V.M. Gun'ko, V.I. Zarko, E.F. Voronin, V.V. Turov, E.M. Pakhlov, E.V. Goncharuk (Ukraine), R. Leboda, E. Chibowski (Poland)
- P-3** Application of Cell Electrophoresis for Study of Rheological Properties of Water Solutions Treated by a Direct Electrical Current
A.I. Miroshnikov, A.V. Gavryushkin, A.Y. Ivanov and V.M. Fomchenkov (Russia)
- P-4**
- P-5** Electrokinetic Phenomena of the Second Kind. Theory. Experiment. Applications
N. Mishchuk (Ukraine) and S. Barany (Hungary)
- P-6** Study of an Electrokinetic Potential Cells *Escherichia coli* at Interaction of Antibodies with a Surface Antigene K99
V.M. Fomchenkov, M.M. Sadikov and A.V. Gavryushkin (Russia)

- P-7 Blood-Compatibility of Particulate Drug Carriers Investigated by Cell-Electrophoresis**
C. Sestier, D. Sabolovic and D. Mazier (France)
- P-8 Measurement of Electrophoretic Velocity of Particles with CE**
K. Yamaberi, Y. Murai, H. Kondo and Y. Hirata (Japan)

■ **Two-Dimensional Electrophoresis, Proteome and Protein Database**

- P-9 Analysis of Alterations of Human Hepatic Bile Protein Patterns after Ursodeoxycholic Acid Treatment Using High Resolution Two-Dimensional Gel Electrophoresis**
H. Chang, S. Fischer and D. Jüngst (Germany)
- P-10 Identification and Comparative Analysis of Minor Proteins of Human Colostrum and Mature Milk by Two-Dimensional Electrophoresis**
K. Murakami (Japan), M. Lagarde (USA), M. Shimizu, J. Koga (Japan) and Y. Yuki (USA)
- P-11 Polypeptide Expression in Human Prostatic Tumors**
A.A. Alaiya, A. Carlsson, B. Franzén, S. Linder, and G. Auer (Sweden)
- P-12 Two-Dimensional Electrophoresis, MALDI-TOF and Microsequencing for the Study of Drug Resistance in Human Tumor Cell Lines**
P. Sinha, D. Schadendorf and H. Lage (Germany)
- P-13 Enrichment of Low-abundance Proteins by Hydroxyapatite Chromatography**
M. Fountoulakis, M.-F. Takécs, D. Röder, P. Berndt, H. Langen and B. Takécs (Switzerland)
- P-14 Differential Protein Expression in the Human Brain**
M. Fountoulakis, R. Hardmeier, P. Berndt (Switzerland), N. Cairns (UK), H. Langen (Switzerland) and G. Lubec (Austria)
- P-15 Two-Dimensional Separation of Human Plasma Proteins Combining Agarose Gel Electrophoresis and Capillary SDS Electrophoresis**
J. Mukai, H. Mizuma, N. Naohara, N. Yamaguchi and T. Manabe (Japan)
- P-16 Protein Spots Comparisons between Non-Denaturing and Denaturing Two-Dimensional Electrophoresis Patterns Using Protein A Agarose and Antibodies**
Y. Shimazaki, S. Ohara, M. Fujiwara and T. Manabe (Japan)
- P-17 Quantitation of Human Plasma Proteins Separated by Micro Two-Dimensional Gel Electrophoresis without Denaturants**
H. Mizuma, N. Yamaguchi and T. Manabe (Japan)
- P-18 Usefulness of Computer Assisted 2D-PAGE Analysis in Proteome Project**
R. Joubert-Caron, J. Feuillard, J.-P. Le Caer (France), M. Schumacher, A. Pollack (Germany), D. Bladier and M. Raphaël (France)
- P-19 Advance in Micro 2-D Electrophoresis Technique – Miniaturization and Simplification of Apparatus and Easy Operation –**
T. Okuyama, S. Kurata, H. Negishi and K. Nishiyama (Japan)
- P-20 Application of an Image Warp Program for the Spot-Matching in 2D Electrophoresis Map**
K. Nishiyama, S. Kurata, H. Negishi and T. Okuyama (Japan)

- P-21 Two-Dimensional Electrophoresis Map of Rat Serum Proteins**
K. Sakaguchi, J. Suzuki, M. Shirai, K. Nishiyama and F. Akahori (Japan)
- P-22 Study of Phosphorylations by One- and Two-dimensional Gel Electrophoresis in Lymphoma B Cells**
M. Fouillit, F. Poirier, D. Bladier, M. Raphaël, M. Caron and R. Joubert-Caron (France)
- P-23 Identification of Apoptosis-Associated Proteins by Two-Dimensional Gel Electrophoresis and Mass Spectrometry in Human Breast Epithelial Cells**
V. Badock, U. Steinhusen, K. Bommert and A. Otto (Germany)
- P-24 Electrophoretic Analysis of Nuclear Matrix Proteins of Rat Liver Cells in Liver Regeneration**
Y.J. Ping, Y.H. Fan, C.T. Liew and E.C. Chew (Hong Kong)
- P-25 Application of 2-D Electrophoresis in the Biopharmaceutical Industry: Analysis of *E. coli* Host Cell Proteins and Immunogenic Polypeptides**
K. Champion, J. Nishihara, S. Frie, D. Arnott, K. O'Connell, J. Stults and M. Vanderlaan (USA)
- P-26 Involvement of Protein Kinase C ϵ in Thyrotropin-releasing Hormone-stimulated Phosphorylation of MARCKS and Keratin in Rat Pituitary Clonal Cells**
Y. Akita, H. Kawasaki, S. Ohno, K. Suzuki and S. Kawashima (Japan)
- P-27 Proteome Analysis of *C. elegans* Two-Dimensional Gel Electrophoresis of Ammonium Sulfate Fractionated Homogenate and Identification of Protein Spots by MALDI-TOF Mass Spectrometry**
H. Kobayashi, T. Usami, Y. Fujisawa, T. Kano, and T. Tsunaki (Japan)
- P-28 Identification of Proteins from Human Lung Cancer Isolated by Two-dimensional Electrophoresis by MALDI-TOF-MS and N-terminal Sequencing**
X.-H. Qian, J.-H. Wan, J.-L. Wang, L. Luo, H.-P. Cheng and F.-C. He (China)
- P-29 Proteome Research Utilising a Hybrid Quadrupole Time of Flight Mass Spectrometer**
D.B. Kristensen, K. Imamura, Y. Miyamoto and K. Yoshizato (Japan)
- P-30 Two-dimensional Protein Map of *Haemophilus influenzae***
H. Langen, B. Takács, P. Berndt, H.-W. Lahm, S. Evers, C. Gray and M. Fountoulakis (Switzerland)
- P-31 Proteomics of *Escherichia coli***
B.J. Walsh, B.R. Herbert, M.P. Molloy, M. Traini, F. Hopwood, K. Ou, M.R. Wilkins, A. Gooley and K.L. Williams (Australia)
- P-32 Electrophoretic Mobility-Based Sequencing of Peptides for Protein Identification**
H. Katayama, Y. Ishihama, Y. Oda and N. Asakawa (Japan)
- P-33 Digestion of Protein Stained with Coomassie Brilliant Blue R-250 in Polyacrylamide Gel**
H. Kawasaki, S. Tanaka and H. Hirano (Japan)

- P-34 Functional Analysis of Proteins Separated by Gel Electrophoresis**
H. Hirano, M. Takaoka, M. Sakita and K. Sakata (Japan)
- P-35 Immobilized PH Gradient Isoelectric Focusing Using Tube Gels**
H. Hirano, H. Kawasaki and H. Sassa (Japan)
- P-36 Two-dimensional Gel Electrophoresis of *in vitro* Translation Products of Human Full-length cDNA Clones**
C. Eguchi and S. Kato (Japan)
- P-37 From a 2D Protein Index towards a Response Regulation Map for *Bacillus Subtilis***
J. Bernhardt, K. Buettner, H. Werner, C. Scharf, R. Schmid, U. Voelker and M. Hecker (Germany)
- P-38 Two-Dimensional Analysis of Posttranslationally Modified Proteins**
P. Gromov and J.E. Celis (Denmark)

■ Cell Function Analysis

- P-39 Heat Stress Increases Thymosin beta 4 and Stathmin in JURKAT Cells of a Human T Lymphoblastic Cell Line**
K. Nakamura, M. Fujimoto, T. Tanaka, M. Aoshima, Y. Kuramitsu, H. Furumoto, K. Takai and Y. Nagasaka (Japan)
- P-40 Stress-Inducible GADD45-related Proteins Activate the Human Stress-responsive MAP Kinase Pathways via the MTK1 MAPKKK**
M. Takekawa, K. Imai (Japan) and H. Saito (USA)
- P-41 BAG-1 Accelerates Cell Motility of Human Gastric Cancer Cells**
Y. Naishiro, M. Adachi, H. Okuda, A. Yawata, T. Mitaka (Japan), S. Takayama, J.C. Reed (USA), Y. Hinoda and K. Imai (Japan)
- P-42 Anti-ErbB-2 Chimeric Monoclonal Antibody Induce Apoptosis to the Human Tumor**
T. Ishida, S. Sasaki, M. Tsujisaki, Y. Hinoda and K. Imai (Japan)
- P-43 Pky2 is a Downstream Mediator in the Jak-mediated Signaling Pathway Activated by IL-2 and IFN- γ : The Critical Role in the Diversification of the Jak Signaling Pathway**
A. Takaoka, N. Tanaka, T. Miyazaki, K. Imai and T. Taniguchi (Japan)
- P-44 Disruption of Lymphocyte Function and Signaling in CD45-Ap-null Mice**
S. Motoya, K. Imai (Japan), A. Matsuda and A. Takeda (USA)
- P-45 Role of Nucleoside Diphosphate Kinases in Differentiation of PC12D Cells**
Y. Ishijima, N. Shimada, M. Fukuda, H. Miyazaki, T. Toda, N. Ishikawa, N.Y. Orlov, T.G. Orlova, T. Yamada and N. Kimura (Japan)
- P-46 Alterations in Brain Proteins by Aging of Senescent Accelerated Mouse (SAMP-8) and Its Sex Differences**
T. Tanaka and K. Nakamura (Japan)

■ Protein Electrophoresis in Pathological Biochemistry

- P-47 **Studies on the Mitochondrial Creatine Kinase in the Fresh Sera from Healthy Subjects and Patients with Hepatitis**
Y. Ueno, M. Tsumura, E. Sumi, Y. Ogino, S. Kuwata and T. Kinouchi (Japan)
- P-48 **Two dUTP-ase Isoforms in Mammalian Tissues**
S. Hokari, I. Koyama, M. Yakushijin, K. Shioda and T. Komoda (Japan)
- P-49 **Two Isoforms of the Intestinal Alkaline Phosphatase Detected with a Proposed Electrophoretic Condition. Re-evaluation.**
M. Matsushita, T. Irino and T. Komoda (Japan)
- P-50 **Deficiency of Lactate Dehydrogenase (LD) Isoenzyme 1 and 2 in Serum and Erythrocytes, due to a Deletion of Three Base (Asparagine) in the LD-H Gene**
N. Houki, K. Sudo, M. Maekawa, T. Okuda, S. Akizuki, A. Ohnishi and K. Kawano (Japan)
- P-51 **Characterization of Isoforms of Two Types of Mitochondrial Creatine Kinase Isolated from Normal Human Brain and Cardiac Muscle**
F. Kanemitsu, T. Kageoka, J. Mizushima, T. Okigaki, K. Taketa and S. Kira (Japan)
- P-52 **The Detection of Alkaline Phosphatase by CE-LIF for Isoenzyme Analysis and Enzyme Immunoassay**
Y. Murakami, A. Koizumi, T. Morita and E. Tamiya (Japan)

■ Lipoprotein, Apolipoprotein and Its Clinical Significance

- P-53 **Detection of Mutations of the Low Density Lipoprotein Receptor Gene by a Denaturing Gradient Gel Electrophoresis**
M. Nagano, H. Hattori, K. Kawamura, T. Egashira and T. Okada (Japan)
- P-54 **Detection of Polymorphism and Mutations of the Apolipoprotein E Gene by a Denaturing Gradient Gel Electrophoresis**
M. Nagano, Y. Sagehashi, T. Iwasaki, K. Kawamura, T. Egashira, and H. Hattori (Japan)
- P-55 **Elevated Apolipoprotein A-I levels in the Tears Associated with Diabetic Retinopathy**
S. Kawai, T. Nakajima, T. Matsunaga, S. Hokari, T. Komoda and K. Kawai (Japan)
- P-56 **Expression of Antioxidant Enzymes in Endothelial Cells by Oxidatively Modified HDL**
T. Matsunaga, T. Nakajima, S. Kawai, S. Hokari, I. Inoue, S. Katayama, J. Kobayashi and T. Komoda (Japan)
- P-57 **Apolipoprotein E2, E3, E4, E5 and E7 Isoforms Isolated by an Isoelectrofocusing Method as the Multiple Banding Pattern; Correlation with Its Genetic Identification**
A. Katagiri, T. Matsuda and S. Kataoka (Japan)
- P-58 **Kringle-4-number-based Apo(a) phenotypes Analysed by SDS-agarose Electrophoresis**
A. Abe, S. Yamada, M. Kawamura, I. Sakurabayashi, H.G. Kraft and G. Utermann (Japan)

- P-59 Clinical Application of Lipoprotein Analysis Using Agarose Gel Electrophoresis**
T. Kido, H. Kurata, A. Matumoto, T. Iwamoto, R. Tobiyama, K. Utsunomiya, S. Tajima,
H. Itakura and K. Kondo (Japan)

■ **DNA Electrophoresis in Molecular Pathology**

- P-60 Manipulation of Curvature in Plasmid DNA Molecules**
N.C. Stellwgen (USA)
- P-61 Pulsed-Field Gel Electrophoresis of Streptococcus Mutans Genomic DNA**
R. Mineyama (Japan)
- P-62 Analysis of Thyroid Transcription Factor-2 (TTF-2) Gene with Extremely High GC Content by PCR-based Sequencing Method in Patients with Thyroid Dysgenesis**
A. Hishinuma, T. Kuribayashi, Y. Kanno, O. Arisaka and T. Ieiri (Japan)
- P-63 Detection of Breast Cancer Micrometastasis in Lymph Nodes by Amplification of Keratin 19 mRNA (K-19) by RT-PCR**
T. Sato, T. Kaneko, T. Nagai, H. Makino, M. Sano, K. Honma, A. Weerasinghe,
Y. Kuwano and T. Abo (Japan)
- P-64 Investigation of Telomerase Activity and K-ras Codon12 Point Mutation in Pancreatic Cancer**
H. Oyama, S. Watanabe, T. Nishino, Y. Fukuya, N. Harada, T. Hatori, T. Imaizumi and
K. Takasaki (Japan)
- P-65 Association between DNA Methylation and Microsatellite Instability in Gastric Cancer**
H. Suzuki, F. Itoh, T. Kikuchi, M. Toyota, M. Kusano, H. Kakiuchi, Y. Hinoda and
K. Imai (Japan)
- P-66 Identification of Aberrantly Methylated CpG Islands in Gastrointestinal Cancer**
F. Itoh, M. Toyota, H. Suzuki, H. Kakiuchi, Y. Hinoda and K. Imai (Japan)
- P-67 PCR-SSCP Analysis of the Androgen Receptor Gene in Androgen Insensitivity Syndrome**
T. Funato, J. Satoh, J. Fujiwara, S. Uehara and T. Sasaki (Japan)
- P-68 Decreased DCC mRNA Expression in Human Gastric Cancers Is Clinicopathologically Significant**
Y. Yoshida, F. Itoh, T. Endo, Y. Hinoda and K. Imai (Japan)

■ **Electrophoresis in Genetic and Forensic Analysis**

- P-69 New Determination Procedures of Carbohydrate-deficient Transferrin for Detecting High Alcohol Consumption**
K. Yoshikawa, K. Umetsu, T. Suzuki, H. Shinzawa, I. Yuasa and H. Katoh (Japan)
- P-70 Fibrinogen Matsumoto II, γ 308Asn->Lys, Leads to Increased Mobility in SDS-PAGE Analysis**
N. Okumura and F. Terasawa (Japan)
- P-71 A Missense Mutation of Fibrinogen γ 153Cys to Arg Leads to Deficiency. – Pulse-chase Analysis Demonstrates Defective Assembly and Secretion of Mutant Fibrinogen –**
F. Terasawa and N. Okumura (Japan)

- P-72 **The Effect of a Genetic Polymorphism of TNF- α on the Clinical Abnormalities Associated with a Mutant β 3-Adrenergic Receptor**
Y. Shima and H. Ohta (Japan)
- P-73 **Molecular Basis of Two Variants of GPT Detected in Paternity Cases**
R. Kumagai, K. Saigusa and Y. Aoki (Japan)
- P-74 **Short Tandem Repeat (STR) Analysis in Japanese**
M. Hashiyada (Japan)
- P-75 **Typing of Haptoglobin and Distribution of Gene Frequencies**
Y. Guo and Y. Fang (China)
- P-76 **Application of Electrophoresis Technology to DNA Analysis**
X. Wang, T. Sawaguchi, S. Li and A. Sawaguchi (Japan)
- P-77

■ Capillary Electrophoresis

- P-78 **Analysis of Histamine in a Single Mast Cell by High-performance Capillary Electrophoresis with On-line Mode In-Capillary Derivatization**
S. Oguri, Y. Ohota, C. Suzuki and A. Tsukamoto (Japan)
- P-79 **Serum Protein Analysis by Capillary Zone Electrophoresis**
H. Ihara, N. Toya, T. Kakinoki, A. Tani, Y. Aoki, N. Hashizume and M. Yoshida (Japan)
- P-80 **Determination of Sialic Acids from Glycoproteins by Capillary Electrophoresis**
F.-Y. Che, X.-X. Shao, K.-Y. Wang, and Q.-C. Xia (China)
- P-81 **Synthesized Short Peptide Splicing *in vitro* Demonstrated by Capillary Electrophoresis**
M. Li, K.M. Chan (Hong Kong) and H.D. Jones (UK)
- P-82 **Capillary Electrophoresis in Polymer Solutions of Rigid Sub-micron Sized Particles: Resolution Optima near the Entanglement Threshold Concentration**
S.P. Radko and A. Chrambach (USA)
- P-83 **Screening for and Confirmation of Urinary Drugs of Abuse by Electrokinetic Capillary-based Multianalyte Immunoassays, Capillary Electrophoresis with Multiwavelength Detection and CE-MS**
J. Caslavská, A. Ramseier, C. Siethoff and W. Thormann (Switzerland)
- P-84 **Automatic DNA Fragment Collector for Gene Discovery Using Capillary Array Gel Electrophoresis**
T. Irie, T. Oshida, H. Hasegawa, Y. Matsuoka, T. Li, Y. Oya, T. Tanaka, G. Tsujimoto and H. Kambara (Japan)
- P-85 **Determination of Underivatized Carbohydrates by Capillary Zone Electrophoresis**
T. Soga (Japan) and D.N. Heiger (USA)
- P-86 **New Bacterial Genotyping Methods Using Mutation Analysis in Denaturing Slab-gel and Capillary Electrophoresis**
C.-H. Brogren and L. Bergstrom (Denmark)

- P-87 Low Concentration Detection of Basic Analytes by Capillary Electrophoresis: Usage of Different Focusing Techniques**
J.P. Quirino and S. Terabe (Japan)
- P-88 Separation and On-Column Detection of Proteins by SDS Gel Electrophoresis in Silica Columns**
N. Naohara, T. Manabe, J. Mukai, H. Mizuma and N. Yamaguchi (Japan)
- P-89 Capillary Isoelectric Focusing of Human Cerebrospinal Fluid Proteins and Sensitive Detection of Specific Peaks in IgG Region for Some Patients**
H. Miyamoto, T. Manabe, K. Inoue and N. Yamaguchi (Japan)
- P-90 Capillary Electrophoresis with Electroosmotic Flow Controlled by External Radial Electric Field and Its Application to Analysis and Separation of Peptides and Proteins**
V. Kasicka, Z. Prusik, P. Sazelova (Czech), M. Chiari (Italy), E. Brynda and J. Stejskal (Czech)
- P-91 Fluorescence-based SSCP Analysis of the LDL Receptor Gene by Capillary Electrophoresis**
T. Walz, J. Geisel, M. Bodis and W. Herrmann (Germany)
- P-92 Analysis of 8-Aminonaphthalene-1,3,6,-trisulfonate-Derivatized Oligosaccharides by Capillary Electrophoresis-Quadrupole Ion Trap Electrospray Mass Spectrometry**
F.-Y. Che, S.J. Fang, K.-Y. Wang and Q.-C. Xia (China)
- P-93 Carbon Film Based-Interdigitated Array Microelectrodes as Electrochemical Detector in Capillary Electrophoresis**
Z. Liu, O. Niwa, R. Kurita, M. Morita and K. Torimitsu (Japan)
- P-94 Point Mutation Detection by Capillary Zone Electrophoresis (CZE)**
C. Gelfi and P.G. Righetti (Italy)
- P-95 Time Dependence of Potential Gradient and Influence on Migration Time in CZE**
N. Ikuta and T. Hirokawa (Japan)
- P-96 High-Sensitive MEKC Analysis of Environmental-Interest Analytes Using On-line Concentration(4)**
H. Hayashibara, S. Yamauchi, K. Otsuka, J.P. Quirino and S. Terabe (Japan)
- P-97 Simultaneous Determination of Bromide, Nitrite, and Nitrate Ions in Seawater by Capillary Zone Electrophoresis Using Artificial Seawater as the Carrier Solution**
K. Fukushi, H. Urayama, S. Takeda, S. Wakida and K. Hiroy (Japan)
- P-98 Rapid Identification of Metallothioneins in Cytosol by Capillary Zone Electrophoresis Using EDTA and a Linear Polyacrylamide-Coated Capillary**
K. Kubo, T. Minami, N. Otaki and M. Kimura (Japan)
- P-99 Capillary Zone Electrophoresis of Albumin-depleted Human Serum Using a Linear Polyacrylamide-Coated Capillary: Separation of Globulins into Individual Components**
K. Kubo, E. Honda, M. Imoto and Y. Morishima (Japan)
- P-100 Evaluation of the Paragon CZE™2000 Capillary Zone Electrophoresis System for Serum Protein Electrophoresis and Monoclonal Component Typing**
M. Daimon, J. Henmi, H. Ohta, N. Kubo, I. Sakurabayashi and H. Saeki (Japan)

- P-101 Characterization of Dissolved Organic Substances in Environmental Waters by Capillary Electrophoresis**
A. Chiba, S. Wakida, S. Takeda, K. Fukushi, K. Higashi, and T. Matsuda (Japan)
- P-102 Capillary Electrophoresis - Large Volume Sample Injection for the Determination of Anionic Dissolved Organic Substances in Surface Water**
S. Takeda, K. Fukushi, M. Yamane, Z. Siroma and S. Wakida (Japan)
- P-103 Affinity Capillary Electrophoresis for Gene Mutation Assay Using Oligonucleotide Immobilized Capillary**
Y. Ozaki, T. Arisawa, Y. Katayama and M. Maeda (Japan)
- P-104 Detection of Hemoglobin and Globin-chain Variants by Capillary Isoelectric Focusing**
M. Sugano, H. Hidaka, T. Nakabayashi, K. Yamauchi, Y. Higuchi, M. Tozuka and T. Katsuyama (Japan)
- P-105 Observation of Protein Folding in Isoelectric Buffers**
E. Stellwagen (USA), C. Gelfi and P.G. Righetti (Italy)
- P-106 Capillary Electrophoresis for Determination of Free and Albumin-bound Bilirubin and the Investigation of Drug Interaction with Bilirubin Bound Albumin**
Y.S. Fung, D.X. Sun and C.Y. Yeung (Hong Kong)
- P-107 "Wrong" Peaks Forming Conditions in High-Voltage Capillary Electrophoresis**
L.L. Frumin, G.V. Zilberstein and S.E. Peltek (Israel)
- P-108 Studies of Protein Crystals by High-performance Capillary Electrophoresis**
J. Sedzik, R. Zhang, S. Hjertén (Sweden)
- P-109 Chiral Capillary Electrophoretic Separation of Higenamine Using Cyclodextrin**
O.-K. Choi (Korea)
- P-110 Capillary Electrophoretic Profiling and Screening of Edible Seeds for Aromatic Amino Acids by Dual Run-Buffer System**
K.-R. Kim, S.-H. La, O.-K. Choi, J.-H. Kim (Korea)
- P-111 Detection of Urinary Bence Jones Proteins by Capillary Zone Electrophoresis**
C. Blessum, M. Andres and N. Khatter (USA)
- P-112 Detection of Non-Protein Components in Serum by Capillary Zone Electrophoresis**
C. Blessum, M. Andres and N. Khatter (USA)
- P-113 Detection of Aberrant Paraproteins by Capillary Zone Electrophoresis**
C. Blessum, M. Andres and N. Khatter (USA)
- P-114 Properties of Interaction Sites on Protein Surfaces. Complex Characterization by Capillary Electrophoresis and Model Calculations.**
F. Kilár, B. Visegrády and L. Póto (Hungary)
- P-115 Sonic Spray Ionization for Capillary Electrophoresis / Mass Spectrometry**
Y. Hirabayashi, A. Hirabayashi and H. Koizumi (Japan)

- P-116 Analysis of Aromatic Compounds by Capillary Electrochromatography with Linear Acrylamide Polymers Containing Hydrophobic Groups**
Y. Kurosu, Y. Satou, N. Ishioka, I. Nagaoka and T. Konakahara (Japan)

■ **Post-Translational Modifications**

- P-117 Comparative Study on the Distribution of Turkey Egg Albumin Glycoforms by Capillary Zone Electrophoresis**
F.-Y. Che, K.-Y. Wang and Q.-C. Xia (China)
- P-118 Comparison of Lectin-binding Patterns between Young Adult and Older Rat Glycoproteins in the Brain**
Y. Sato, Y. Nakano, A. Kobata, M. Tomita and T. Endo (Japan)
- P-119 N^α-Acetylation and Function of Yeast 20S Proteasome**
Y. Kimura, M. Takaoka, S. Tanaka, K. Tanaka and H. Hirano (Japan)
- P-120 Reduction of Tyrosine-phosphorylated Proteins in Involutional Thymuses of Stressed Rats: A Study Using Immunological Methods**
H. Nishio, H. Tsuji, A. Tamura, K. Suzuki (Japan)

■ **New Fields in Electrophoresis**

- P-121 Staining of Biopolymers (Protein or DNA) in Gel Matrix by Mixed-Dye Staining Techniques**
J.-K. Choi, D.-W. Jung, G.-H. Tak, Y.-I. Yang and G.-S. Yoo (Korea)
- P-122 Thermal Experiment of Continuous Free-flow Electrophoresis (CFE)**
H. Wang, H. Wu and Z. Zhang (China)
- P-123 Computer Simulation of Sodium Dodecyl Sulfate-Polyacrylamide Gel Electrophoresis**
K. Shimao (Japan)
- P-124 Two Novel Myogenic Factors Were Identified and Isolated by Sequential Isoelectric Focusing Electrophoresis**
M. Li, D.Q. Cai, Y. Wang, Z. Li, K.M. Lee and K.M. Chan (Hong Kong)
- P-125 Analytical Solution Focusing Problem**
L.L. Frumin, G.V. Zilberstein and S.E. Peltek (Israel)
- P-126**
- P-127 Age Related Changes of Aqueous Protein Profiles in Fast and Slow Twitch Skeletal Muscle in Rats**
D.Q. Cai, M. Li, K.M. Chan and K.M. Lee (Hong Kong)
- P-128 Identification of Specific Protein Markers for Differentiating Fast and Slow Twitch Muscle Fibers**
D.Q. Cai, K.M. Chan, M. Li and K.M. Lee (Hong Kong)
- P-129 The Detection of Picoplankton 16S rDNA in Cases of Drowning**
M. Kane, Y. Yamamoto, I. Ushiyama, A. Nishimura and K. Nishi (Japan)

- P-130 Oral Micro-organism Binding of Human Salivary Histatins**
J.A. Beeley and D. Ramsay (UK)
- P-131 Detection of Antinuclear Antibodies by Immunoblotting**
Y. Imafuku, K. Honda, T. Nagai and H. Yoshida (Japan)
- P-132 Ion Transport Phenomena in Focalisation Electrophoresis Processes for the Separation of Rare Earth Metal**
A.I. Vieira Nunes, C.P. De Souza (Brazil) and F. Lapicque (France)
- P-133 Dynamics of DNA in Polyacrylamide Solutions studied by Electrical Birefringence**
K. Starchev, J. Sturm and G. Weill (France)

■ **Electrophoresis in Clinical Analysis**

- P-134 Characteristics of Cryoglobulin Particles**
T. Okazaki, K. Moriya, H. Matsuura, T. Nakagawa and T. Kanno (Japan)
- P-135 Serum Amyloid A (SAA) Levels In Plasma Is Influenced by SAA1 Alleles**
T. Yamada (Japan) and A.P. McDonald (USA)
- P-136 Modified Agarose Electrophoresis Followed by Immunoblotting for Detection of Oligoclonal Ig-G Bands in Unconcentrated Cerebrospinal Fluids**
M. Arai, M. Nakatsu and K. Shiba (Japan)
- P-137 Characterization of Extracellular Products by Group A Streptococci Isolated from Patient with Streptococcal Toxic Shock Syndorome**
J. Suzuki and K. Sakaguchi (Japan)
- P-138 Molar Heterogeneity of Urinary Transferrin in the Patients with Diabetic Nephropathy**
Y. Kurihara, K. Shiba, S. Kamei, S. Iijima, M. Kimura, N. Sakai and S. Hosaki (Japan)
- P-139 Occurrence of H Chain of 7S IgM Half-molecule whose N-terminal Sequence is Identical with That of κ L Chain in a Patient with Waldenström Macroglobulinemia**
M. Imoto, T. Kimura, T. Akiyama, I. Furuta, K. Yamamoto, H. Sinohara and I. Sakurabayashi (Japan)
- P-140 Immuno-electrophoretic Analysis of Protein A-Purified Murine IgG1**
Y. Yoshizawa and M. Watanabe (Japan)
- P-141 A Case of "Fragment Disease" with Delta Heavy Chains and Lambda Light Chains**
M. Yanai, S. Hashimoto, K. Kumasaka, Y. Matsukawa, K. Morimoto, S. Nishinarita and K. Kawano (Japan)
- P-142 Immunochemical Properties of IgG-Albumin Complexes in a Patient with Pneumonia**
H. Sato, K. Fujita, I. Sakurabayashi, M. Kaimori, and R. Wada (Japan)
- P-143 Immunoblot Analysis of Components of Aspergillus Species Recognized by IgE Antibodies in Sera from Pig Farm Workers**
Y.-M. Chiung, B.-L. Lin and H.-D. Shen (Taiwan)

- P-144 HSP70 Related Epitopes are Common Allergenic Determinants for Barley and Corn Antigens**
Y.-M. Chiung and B.-L. Lin (Taiwan)
- P-145 A Case of IgG Type Multiple Myeloma Converted from Monoclonal Gammopathy of Undetermined Significance at a Short Term Interval**
S. Shiohira, K. Fujita, I. Sakurabayashi, K. Heshiki and T. Miyaguni (Japan)
- P-146 Investigation of the Electrophoretic Analysis System for Routine Practice**
K. Kawamura, E. Nagano, Y. Okuzumi and M. Mori (Japan)
- P-147 Association between Enzyme-linked Immunoglobulins and Antinuclear Antibodies**
K. Kubota, T. Tozawa and K. Akano (Japan)
- P-148 Measurement of Serum LDL-cholesterol in Patients with Hypertriglycemia**
Y. Horiuchi, K. Takanohashi, S. Oikawa, A. Numabe, A. Hishinuma, T. Ieiri (Japan)
- P-149 An Another Aspect of Lipid Lowering Agent Using Agarose Gel Electrophoresis**
H. Kurata, K. Uehara, K. Utsunomiya, T. Kido, T. Iwamoto, K. Kondo, R. Tobiyama, H. Itakura, N. Hashimoto and N. Tajima (Japan)
- P-150 Rapid Immunoelectrophoresis Technique for the Diagnosis of Helminthiasis, Systemic Mycoses, and Hypersensitivity Pneumonitis**
P. Recco, R. Falcou (France), C. Blessum (USA), A. Monier, V. Sans and J.P. Seguela (France)

INTERNET ONLINE POSTER SESSIONS

Internet Online Poster Sessions are open at the Virtual Conference Hall:
[<http://proteome.tmig.or.jp/JES/ICES/OLP/olp.html>]

Networking computers for free access to the Virtual Conference Hall are available in the Exhibition Hall during the meeting. Presenters and registered audience may also attend the poster sessions and join the electric discussion from outside of the meeting room by internet connection.

The latest version of program of the INTERNET ONLINE POSTER SESSIONS is announced at the Exhibition Hall.

LUNCHEON SEMINARS

(International Meeting Hall)

■ Luncheon Seminar 1 (L25) (12:45-13:45, May 25)

Clinical Capillary Electrophoresis – What Can Be Seen through Capillary

Chairperson: I. Sakurabayashi (Japan)

Serum Protein Fractionation Analysis by Paragon CZE™ 2000 Fully Automated
Capillary Electrophoresis

Masahiro Daimon (Jichi Medical School)

Providing Electrophoresis Interpretation in a Cost-Controlled Environment

Carl R. Jolliff (Physicians' Laboratory Services, Inc.)

Development of a Capillary Zone Electrophoresis System for Routine Clinical Use

Cynthia Blessum (Beckman Coulter Inc.)

(Presented by Beckman Coulter Inc.)

■ Luncheon Seminar 2 (L26) (12:45-13:45, May 26)

Proteome Works™ System for Proteome Discovery

Emily Dale (Bio-Rad Laboratories)

(Presented by Nippon Bio-Rad Laboratories)

■ Luncheon Seminar 3 (L27) (12:45-13:45, May 27)

Chairperson: T. Toda (Japan)

Proteomic Analysis on the Basis of Two-Dimensional Electrophoresis

1) Angelika Görg (Technische Universität München, Lehrstuhl für Allgemeine
Lebensmittel Technologie)

2) Rolf Ehrnström (Amersham Pharmacia Biotech)

(Presented by Amersham Pharmacia Biotech)

GENERAL INFORMATION

- **Dates:** May 25 (Tue.) - 28 (Fri.), 1999
- **Venue:** Omiya Sonic City
1-7-5 Sakuragi-cho, Omiya City, Saitama 331-0852, Japan
- **Hosted by:** Japanese Electrophoresis Society (Established in 1950)
ICES '99 Organizing Committee
- **Supported by:** Japan Society for Biomedical Gerontology
Japan Society of Clinical Chemistry
Japanese Association of Medical Technologists
Japanese Society of Legal Medicine
Japanese Society of Veterinary Science
The Japan Society for Analytical Chemistry
The Japan Society of Clinical Pathology
The Japanese Biochemical Society
The Pharmaceutical Society of Japan
The Society for Chromatographic Sciences
(in alphabetical order)
Japan National Tourist Organization
The Commemorative Association for
the Japan World Exhibition (1970)

■ **Official Language:** English

■ **ICES '99 News in WWW**

Information of the meeting can be obtained via internet at:

<http://www.tmig.or.jp/JES/ICES/ices99.html>

■ **Registration**

Registration desk is located on the 4th floor of the Hall Wing. Registration hours are as follows:

May 24 (Mon.) 17:00-18:30

May 25 (Tue.)-27 (Thu.) 9:00-17:00

May 28 (Fri.) 9:00-13:00

Those who have registered in advance will receive a Congress bag containing the "Program & Abstracts" and a name tag at the Registration Desk upon presenting their registration cards. For on-site registration, participants must fill out the Registration Form and pay the late registration fee.

Participants are required to wear the name tag when attending the Scientific Sessions as well as Social Programs.

■ Proceedings

Proceedings, a special issue of the journal ELECTROPHORESIS (Wiley-VCH), will be published after the meeting. The cost is ¥4,500/issue including postage. Those who wish to purchase a copy should check the appropriate box on the Registration Form and pay the fee at the registration desk. Proceedings will be sent directly from the publisher.

■ Information Desk and Message Board

Information Desk will be in the lobby of the International Meeting Hall (4th floor).

A Message Board will be provided in the lobby. Any program changes and urgent announcement from the secretariat will be posted on the Message Board. Incoming mail and fax messages addressed to the congress participants will be also placed on the Message Board.

■ Hotel Accommodation and Travel Assistance (JTB Desk)

Assistance with hotel accommodation can be obtained from the JTB (Japan Travel Bureau) Desk in the lobby. Their booth will be open all day during the meeting to assist participants with their travel arrangements and airline reconfirmation for their return flights.

■ Meals and Refreshment

Refreshments will be served free of charge. There are several restaurants inside the Omiya Sonic City and many others including coffee shops at reasonable prices in the immediate vicinity of the complex.

■ Communication Services

Post office is located in the basement floor of the Building Wing.

Public phones can be found at various places in the Omiya Sonic City. Gray-colored public phones can be used for international calls.

Public fax machines are also available in the complex; however, no internet facilities are provided.

■ Lost and Found

Inquiries concerning lost properties will be handled at the Information Desk.

■ Airport Tax

All air travelers leaving Japan will be required to pay an airport tax of ¥2,040 from New Tokyo International Airport (Narita) or ¥2,650 from Kansai International Airport, payable only in Japanese yen. All other international airports in Japan such as Haneda, Osaka and others do not require the airport tax. For those leaving Japan from Narita Airport, the airport has two terminal buildings, Terminal 1 and Terminal 2. Please make sure of the terminal building of your airline.

■ Customs

Japanese customs is fairly lenient and allows bringing in items necessary for personal use.

Duty-free imports are: 3 bottles of liquor; 200 cigarettes or 50 cigars; 2 ounces of perfume; gifts and souvenirs other than the above whose total market value does not exceed ¥200,000.

Strictly prohibited are firearms and other types of weapons, and narcotics.

■ **Tax:** There is a consumption tax of 5% on all expenditures.

■ **Tipping:** In Japan, tips are not necessary, even at hotels and restaurants.

■ **Climate**

The temperature in Omiya during the period of the meeting ranges between 14°C and 23°C.

■ **Currency Exchange**

Only Japanese yen (¥) is accepted at regular stores and restaurants. Certain foreign currencies and credit cards may be accepted at a limited number of hotels, restaurants and souvenir shops. You can exchange currencies at foreign exchange banks and other authorized money exchangers on presentation of your passport.

■ **Traveler's Checks and Credit Cards**

Traveler's checks are accepted only at leading banks and major hotels in principal cities, and the use of traveler's checks in Japan is not as popular as in some other countries. MasterCard, Diners Club, Visa and American Express are widely accepted at hotels, department stores, shops and restaurants.

■ **Electrical Appliance**

Japan operates on 100-110 volts for electrical appliances. The frequency is 50 Hz in eastern Japan including Tokyo and Omiya and 60 Hz in western Japan including Kyoto.

■ **Shopping**

Business hours of department stores are generally from 10:00 to 19:00. They are open on Sundays and national holidays, but closed either on Mondays, Wednesdays or Thursdays.

Business hours for retail shops differ from one another, but usually from 10:00 to 20:00, and are open on Sundays and national holidays.

■ **Time Zone:** Japan standard time is 9 hours ahead of Greenwich Mean Time.

■ **Insurance**

The Organizing Committee will not accept liability for personal injuries or for loss or damage to property belonging to participants, either during or as a result of the meeting or during any tours.

Delegates are thus encouraged to obtain travel insurance (medical, personal, accident, and/or luggage) in their home country prior to departure.

OPTIONAL TOURS

OP-1 OMIYA HALF-DAY

Date: May 25 (Tuesday) 9:00 - 12:30

Fare: ¥7,500 (per person)

Assemble place: Entrance Hall of Sonic City, Building Wing

Sightseeing points:

- * Hikawa Jinja: The shrine is said to have been built more than 2,400 years ago and was rebuilt a number of times. Currently, there are more than 290 Hikawa Jinja in Japan and the fact that this shrine is the center of all the Hikawa Jinja illustrates the historical importance of Omiya as the birthplace of the nation's rapid ethnological and political development.
- * Bonsai Village: The place where people gain skills and spiritual growth through bonsai. Many of the people who have studied at the village are now active leaders of bonsai all over the world.

OP-2 TOKYO FULL-DAY

Date: May 26 (Wednesday) 9:00 - 16:00

Fare: ¥13,500 (per person)

Assemble place: Entrance Hall of Sonic City, Building Wing

Sightseeing points:

- * Imperial Palace Plaza: The palace became the Imperial Family residence after the Meiji Restoration in 1868. It is in the heart of Tokyo covering an area of 101ha. (250 acres).
- * Asakusa Kannon Temple: This ancient temple is one of the major symbols of old Tokyo with its two great gates and rows of traditional family shops and stalls, called "Nakamise."
- * Edo Tokyo Museum: Various displays of museum galleries enable visitors to learn the history, life style and culture of Tokyo. Those of Edo period (17th-19th century) are also displayed.

OP-3 KAWAGOE FULL-DAY

Date: May 27 (Thursday) 9:00 - 16:00

Fare: ¥12,000 (per person)

Assemble place: Entrance Hall of Sonic City, Building Wing

Sightseeing points:

- * Kawagoe Castle (Honmaru Goten): Honmaru Goten is a huge structure built in 1848, as a main residence of Kawagoe Castle. It has been converted into a museum with archaeological artifacts and pictures of culture properties.
- * Tokino Kane (Bell Tower): This "Bell Tower" is the symbol of historical Kawagoe town, originally built in 1624.
- * Kawagoe City Museum: The city museum was built in 1980 to collect and display the precious, cultural properties which are left today in Kawagoe city, the city often called "Little Edo," one of the typical castle town in the Kanto area.
- * Kitain Temple: The head Tendai Sect temple of the Kanto area boasts several beautiful gardens in its precinct. Planted with plum, cherry, and maple trees, plus a variety of flowers, particularly hydrangeas and azaleas, the gardens change their colors throughout the year.

OP-4 NIKKO FULL-DAY

Date: May 28 (Friday) 9:00 - 17:30

Fare: ¥14,000 (per person)

Assemble place: Entrance Hall of Sonic City, Building Wing

Sightseeing points:

- * Toshogu-gu shrine, designated as a national treasure, is comprised of many magnificent wooden buildings covered in gold and richly colored ornamentation. This synthesis of Buddhist and Shinto architecture includes a five-story pagoda, belfry, drum tower, 'torii'gate, and sacred cistern.
- * Rinno-ji Temple: Riinoji, the head temple of the Tendai-shu Sect, is a huge temple complex which consists of one main temple and 15 minor temples, and boasts a large congregation of followers.

- Note:
- 1) Please prepare walking shoes when you join the tour.
 - 2) Places to visit are subject to change with or without notice.
 - 3) Tours may be cancelled when the number of participants fails to reach 20.

ACCESS TO MEETING SITE

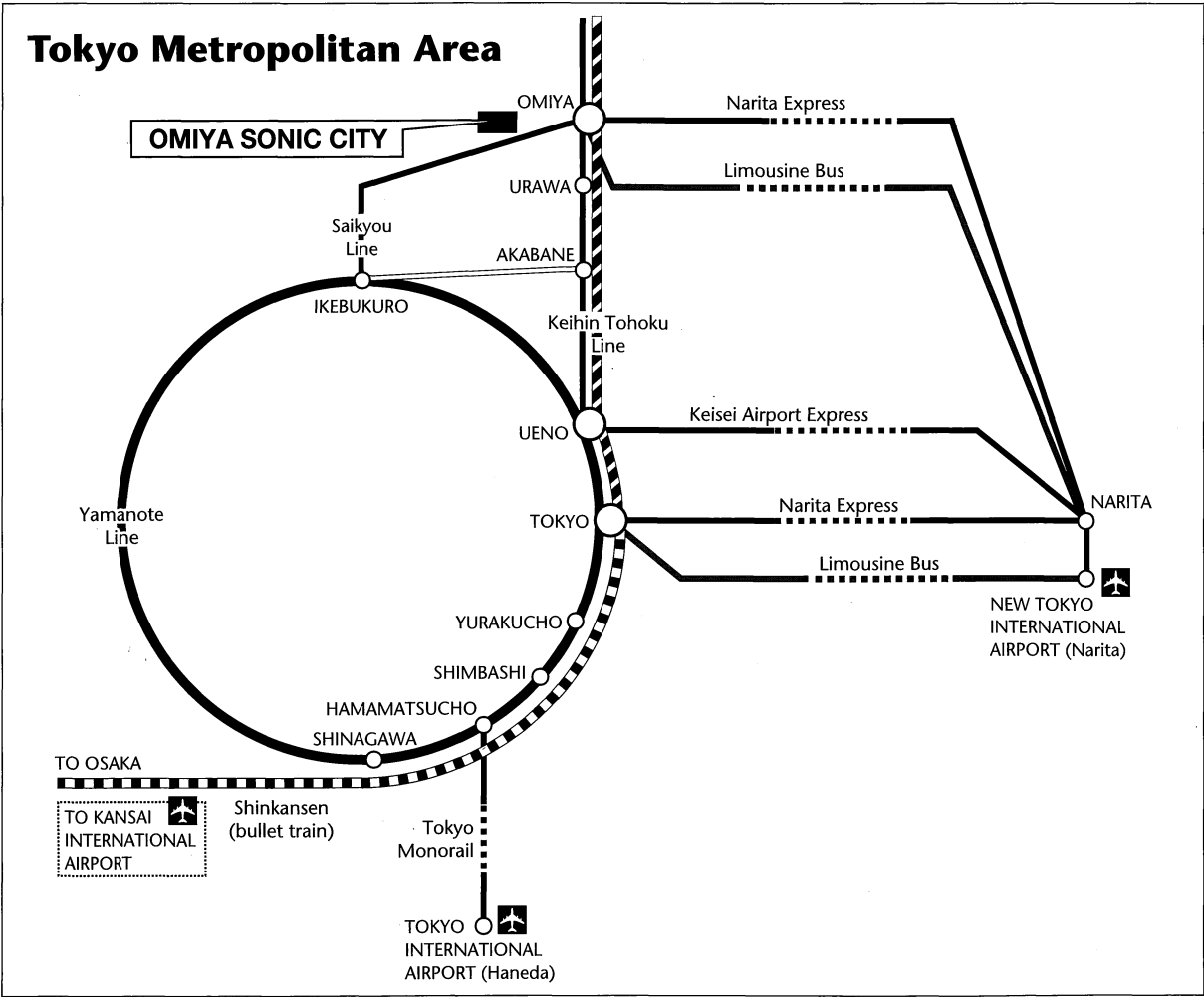
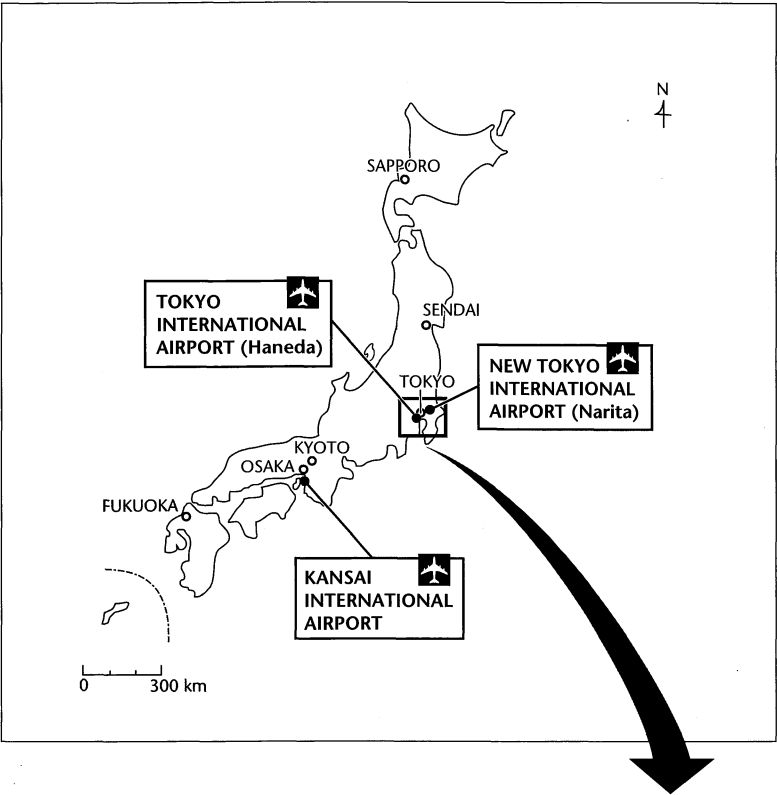

■ Omiya/Yono Area

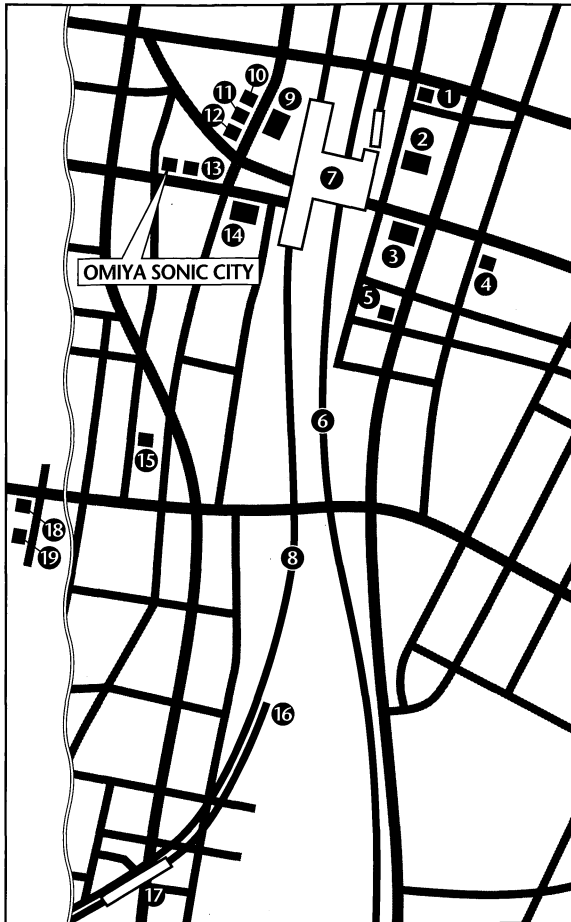

- ① OMIYA PIOLAND HOTEL
- ② SEIBU DEPT. STORE
- ③ TAKASHIMAYA DEPT. STORE
- ④ OMIYA CYTY HALL
- ⑤ OWL HOTEL OMIYA
- ⑥ KEIHIN TOHOKU LINE
- ⑦ JR OMIYA STATION
- ⑧ TOHOKU AND JOETSU SHINKANSEN
- ⑨ MARUI DEPT. STORE
- ⑩ MARROAD INN OMIYA
- ⑪ DAIEI SUPERMARKET
- ⑫ TOKYO SOWA BANK
- ⑬ PALACE HOTEL OMIYA
- ⑭ SOGO DEPT. STORE
- ⑮ OMIYA RED CROSS HOSPITAL
- ⑯ SAIKYOÛ LINE
- ⑰ KITA-YONO STATION
- ⑱ HIGH SCHOOL
- ⑲ YONO DAI-ICHI HOTEL

■ Urawa Area

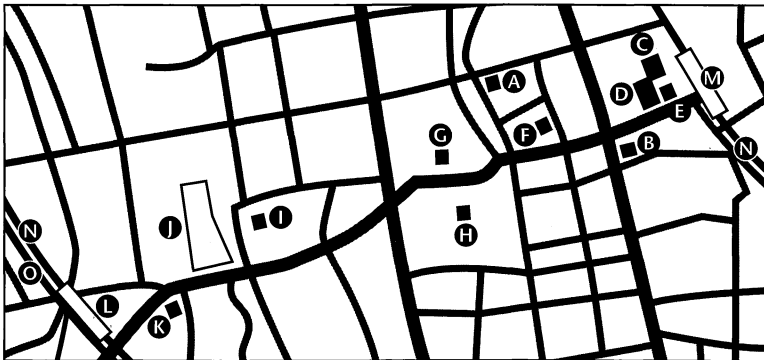

- | | |
|------------------------------|--------------------------------|
| ① URAWA TOBU HOTEL | ① JUNIOR HIGH SCHOOL |
| ② URAWA WASHINGTON HOTEL | ② BESSHONUMA PARK |
| ③ ISETAN DEPT. STORE | ③ OJI SHINKIN BANK |
| ④ COMMUNITY PLAZA-CORSO | ④ NAKA-URAWA STATION |
| ⑤ ASAHI BANK | ⑤ URAWA STATION |
| ⑥ SAITAMA HALL | ⑥ TOHOKU HONSEN LINE |
| ⑦ SAITAMA PREFECTURAL OFFICE | ⑦ TOHOKU AND JOETSU SHINKANSEN |
| ⑧ PUBLIC PROSECUTOR'S OFFICE | |

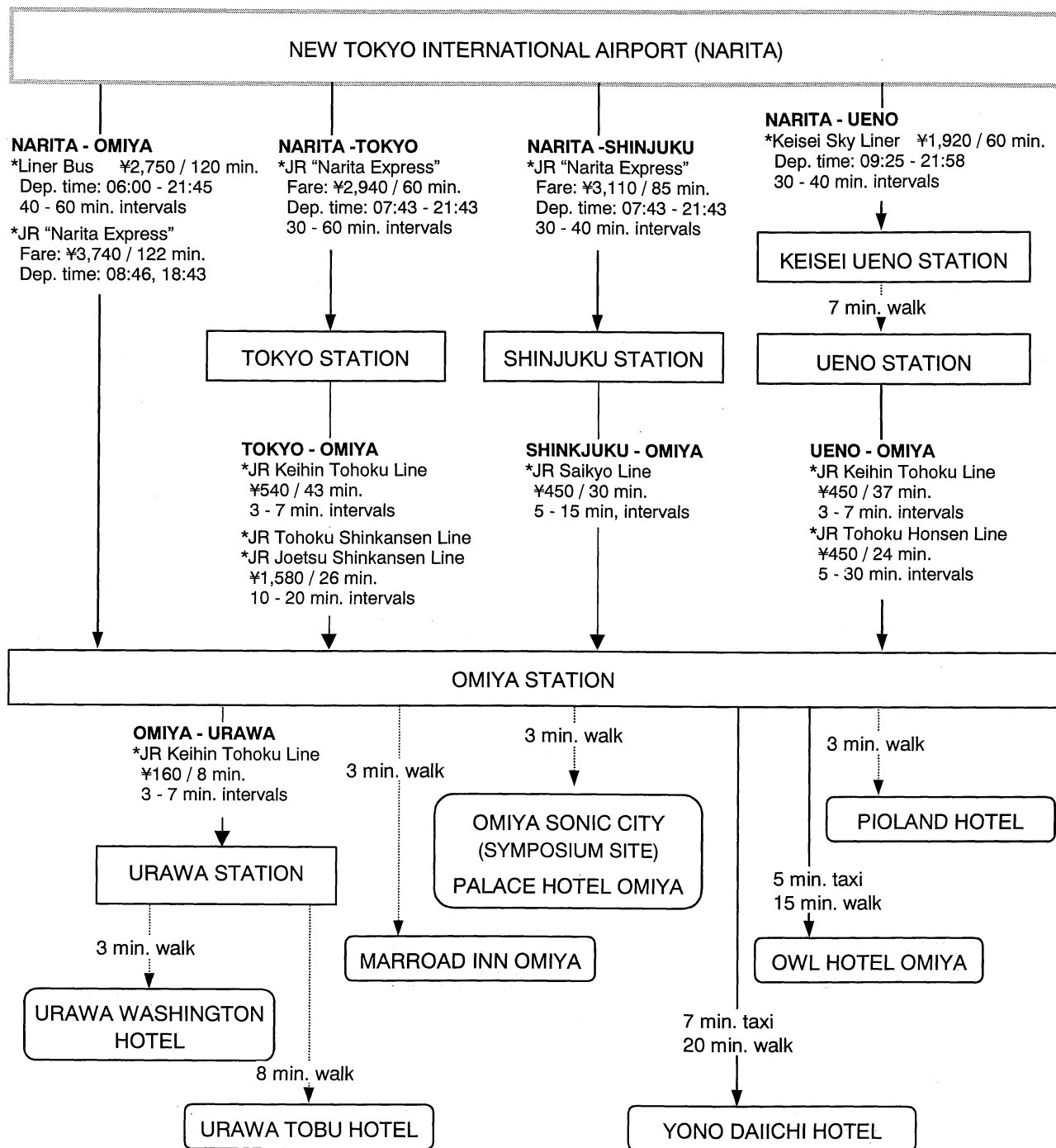

(as of April, 1999)

